

- EN User Manual
- FR Guide d'utilisation
- ES Guía de usuario
- DE Bedienungsanleitung
- NL Gebruikershandleiding
- IT Manuale d'uso
- PT Manual do utilizador
- GR Οδηγός χρήσης
- TR Kullanım kılavuzu
- DK Brugervejledning
- SV Användarhandbok
- PL Käyttöohje
- FI Instrukcija obsługi
- CS Uživatelská příručka
- SK Návod na použitie
- HU Felhasználói kézikönyv
- RU Руководство по эксплуатации

SCB4330CB
SCB4356NB
SCB4365NB
SCB4380NB

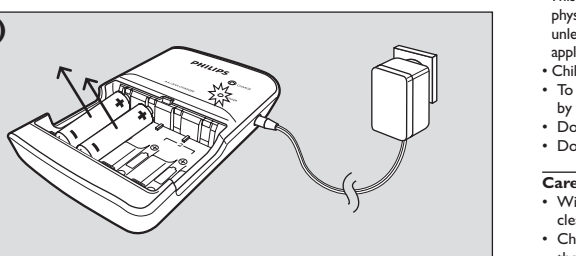
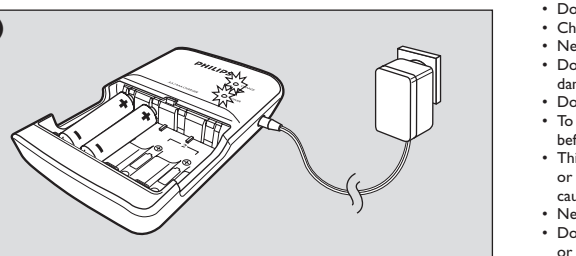
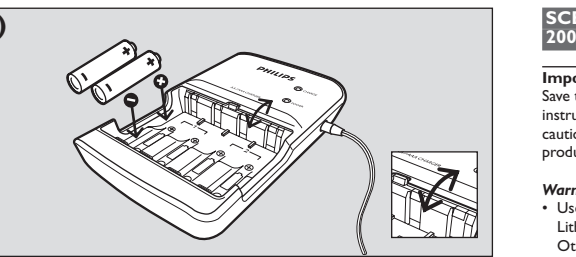

PHILIPS

Battery charging times:

Battery size	Battery capacity (mAh)	Approx. charging time
AA Ni-MH	2600 mAh	5 hrs
AA Ni-MH	2450 mAh	4 ½ hrs
AA Ni-MH	2100 mAh	4 hrs
AA Ni-MH	1800 mAh	3 ½ hrs
AA Ni-MH	1300 mAh	2 ½ hrs
AAA Ni-MH	900 mAh	5 hrs
AAA Ni-MH	700 mAh	3 ½ hrs

Note: It is normal for the unit and the batteries to become warm while charging.

Charging batteries

- Insert batteries in the charger.
- For AAA batteries flip down the charger contacts. See fig. A.
- Connect the DC output plug of the adapter into the DC input jack of the charger and plug the adapter into a household electric outlet. See fig. B.
- The green POWER LED will illuminate.
- The red CHARGE LED will illuminate indicating that charging is in progress.
- > If any of the batteries is not installed correctly, the CHARGE LED will not light and the charger will not charge empty batteries.
- > If any of the batteries is not suitable for charging (i.e. a bad battery), the CHARGE LED will flash red and the battery/batteries will not be charged.
- When the batteries are fully charged, the red CHARGE LED will turn off.
- The charger will now switch over to trickle charge to keep your batteries fully charged for use.
- When you are going to use the batteries, disconnect the plug from the outlet and remove the batteries. See fig. C. Always unplug when charged!
- The SCB4330NB battery charger can be powered by the car's 12V DC accessory (cigarette lighter) socket. Only use the supplied car cord.

Additional information (including warranty conditions) available at our website: www.philips.com/support

Specifications subject to change without notice. All dimensions shown are approximate.

SCB4330CB/SCB4356NB/SCB4365NB/SCB4380NB
200 min (car) charger

Important Safety Instructions:

Use these instructions - this manual contains important safety and operating instructions for this charger. Before using your charger read all instructions and caution markings on the charger, the batteries to be charged and the products that use the battery.

Warning:

- Use to charge Ni-MH batteries only. Do not charge Alkaline, Zinc Carbon, Lithium or any other type of battery not specified on the charger.
- Other types of batteries might burst or leak causing personal injury.
- For proper battery insertion, please observe pole indications (+/-). See fig. A.
- Do not dispose of in fire, short circuit or open.
- Charge new batteries before using.
- Never alter the AC cord or plug.
- Do not operate the charger if it has been subjected to shock or if it is damaged.
- Do not disassemble the charger.
- To avoid risk of electric shock, unplug the charger from the electrical outlet before cleaning or when not in use.
- This battery charger is for indoor use only. Do not expose the charger to rain or excessive moisture. Keep the charger away from dust and dirt, which can cause premature wear of parts or harm its normal operation.
- Never use the charger as a power source for any electrical equipment.
- Do not incinerate, disassemble or short circuit batteries since they may burst or release toxic materials.
- This appliance is not intended for use by persons (including children) with reduced physical, sensory or mental capabilities, or lack of experience and knowledge, unless they have been given supervision or instruction concerning use of the appliance by a person responsible for their safety.
- Children should be supervised to ensure that they do not play with the appliance.
- To reduce the risk of damage to the AC plug and cord, disconnect the charger by pulling the plug and not the cord.
- Do not operate the charger if the cord or plug is damaged.
- Do not charge damaged or leaking batteries.

Care:

- Wipe the charger with a damp cloth occasionally without harsh chemicals, cleaning solvents or strong detergents.
- Charger and batteries must be disposed of separately. Inform yourself about the separate collection system for electrical and electronic products.

Operating Instructions

General charging guidelines

- At the same time you can charge 2 or 4 AA/AAA batteries. If you charge only two batteries, insert them in the first two slots on the left side.
- For long battery life, always charge empty batteries.
- When charging, ambient temperature should be between 0°C and 40°C (32°F and 104°F).
- You can only charge batteries of the same size and type (AA/AAA).
- Make sure batteries in each pair of slots (1/2 and/or 3/4) are identical (same capacity and size).

Note: It is normal for the unit and the batteries to become warm while charging.

Charging batteries

- Insert batteries in the charger.
- For AAA batteries flip down the charger contacts. See fig. A.
- Connect the DC output plug of the adapter into the DC input jack of the charger and plug the adapter into a household electric outlet. See fig. B.
- The green POWER LED will illuminate.
- The red CHARGE LED will illuminate indicating that charging is in progress.
- > If any of the batteries is not installed correctly, the CHARGE LED will not light and the charger will not charge empty batteries.
- > If any of the batteries is not suitable for charging (i.e. a bad battery), the CHARGE LED will flash red and the battery/batteries will not be charged.
- When the batteries are fully charged, the red CHARGE LED will turn off.
- The charger will now switch over to trickle charge to keep your batteries fully charged for use.
- When you are going to use the batteries, disconnect the plug from the outlet and remove the batteries. See fig. C. Always unplug when charged!
- The SCB4330NB battery charger can be powered by the car's 12V DC accessory (cigarette lighter) socket. Only use the supplied car cord.

Battery charging times:

Battery size	Battery capacity (mAh)	Approx. charging time
AA Ni-MH	2600 mAh	5 hrs
AA Ni-MH	2450 mAh	4 ½ hrs
AA Ni-MH	2100 mAh	4 hrs
AA Ni-MH	1800 mAh	3 ½ hrs
AA Ni-MH	1300 mAh	2 ½ hrs
AAA Ni-MH	900 mAh	5 hrs
AAA Ni-MH	700 mAh	3 ½ hrs

Note: It is normal for the unit and the batteries to become warm while charging.

Charging batteries

- Insert batteries in the charger.
- For AAA batteries flip down the charger contacts. See fig. A.
- Connect the DC output plug of the adapter into the DC input jack of the charger and plug the adapter into a household electric outlet. See fig. B.
- The green POWER LED will illuminate.
- The red CHARGE LED will illuminate indicating that charging is in progress.
- > If any of the batteries is not installed correctly, the CHARGE LED will not light and the charger will not charge empty batteries.
- > If any of the batteries is not suitable for charging (i.e. a bad battery), the CHARGE LED will flash red and the battery/batteries will not be charged.
- When the batteries are fully charged, the red CHARGE LED will turn off.
- The charger will now switch over to trickle charge to keep your batteries fully charged for use.
- When you are going to use the batteries, disconnect the plug from the outlet and remove the batteries. See fig. C. Always unplug when charged!
- The SCB4330NB battery charger can be powered by the car's 12V DC accessory (cigarette lighter) socket. Only use the supplied car cord.

Battery charging times:

Battery size	Battery capacity (mAh)	Approx. charging time
AA Ni-MH	2600 mAh	5 hrs
AA Ni-MH	2450 mAh	4 ½ hrs
AA Ni-MH	2100 mAh	4 hrs
AA Ni-MH	1800 mAh	3 ½ hrs
AA Ni-MH	1300 mAh	2 ½ hrs
AAA Ni-MH	900 mAh	5 hrs
AAA Ni-MH	700 mAh	3 ½ hrs

Note: It is normal for the unit and the batteries to become warm while charging.

Charging batteries

- Insert batteries in the charger.
- For AAA batteries flip down the charger contacts. See fig. A.
- Connect the DC output plug of the adapter into the DC input jack of the charger and plug the adapter into a household electric outlet. See fig. B.
- The green POWER LED will illuminate.
- The red CHARGE LED will illuminate indicating that charging is in progress.
- > If any of the batteries is not installed correctly, the CHARGE LED will not light and the charger will not charge empty batteries.
- > If any of the batteries is not suitable for charging (i.e. a bad battery), the CHARGE LED will flash red and the battery/batteries will not be charged.
- When the batteries are fully charged, the red CHARGE LED will turn off.
- The charger will now switch over to trickle charge to keep your batteries fully charged for use.
- When you are going to use the batteries, disconnect the plug from the outlet and remove the batteries. See fig. C. Always unplug when charged!
- The SCB4330NB battery charger can be powered by the car's 12V DC accessory (cigarette lighter) socket. Only use the supplied car cord.

Battery charging times:

Battery size	Battery capacity (mAh)	Approx. charging time
AA Ni-MH	2600 mAh	5 hrs
AA Ni-MH	2450 mAh	4 ½ hrs
AA Ni-MH	2100 mAh	4 hrs
AA Ni-MH	1800 mAh	3 ½ hrs
AA Ni-MH	1300 mAh	2 ½ hrs
AAA Ni-MH	900 mAh	5 hrs
AAA Ni-MH	700 mAh	3 ½ hrs

Note: It is normal for the unit and the batteries to become warm while charging.

Charging batteries

- Insert batteries in the charger.
- For AAA batteries flip down the charger contacts. See fig. A.
- Connect the DC output plug of the adapter into the DC input jack of the charger and plug the adapter into a household electric outlet. See fig. B.
- The green POWER LED will illuminate.
- The red CHARGE LED will illuminate indicating that charging is in progress.
- > If any of the batteries is not installed correctly, the CHARGE LED will not light and the charger will not charge empty batteries.
- > If any of the batteries is not suitable for charging (i.e. a bad battery), the CHARGE LED will flash red and the battery/batteries will not be charged.
- When the batteries are fully charged, the red CHARGE LED will turn off.
- The charger will now switch over to trickle charge to keep your batteries fully charged for use.
- When you are going to use the batteries, disconnect the plug from the outlet and remove the batteries. See fig. C. Always unplug when charged!
- The SCB4330NB battery charger can be powered by the car's 12V DC accessory (cigarette lighter) socket. Only use the supplied car cord.

SCB4330CB/SCB4356NB/SCB4365NB/SCB4380NB
Chargeur 200 min

Instructions importantes liées à la sécurité

Conservez ces instructions - ce manuel contient des consignes de sécurité et des instructions d'utilisation importantes pour ce chargeur. Avant toute utilisation, lisez les instructions et les notes de précautions relatives au chargeur, aux piles à charger et aux appareils fonctionnant avec ces piles.

Avertissements:

- Utilisez le chargeur uniquement pour charger les piles Ni-MH. Évitez de charger des piles alcalines, au zinc-carbone, au lithium ou tout autre type de pile non indiquée sur le chargeur. Les autres types de piles présentent des risques d'explosion ou de fuite, susceptibles de provoquer des blessures corporelles.
- Pour insérer correctement les piles, respectez les indications de polarité (+/-). Voir la fig. A.
- Évitez de jeter les piles dans le feu, de les ouvrir ou de les court-circuiter.
- Neuue Akkus vor dem Gebrauch laden.
- Chargeur toujours à l'abri de la poussière et de la saleté, qui peuvent causer une usure prématurée ou gêner son fonctionnement normal.
- Ne modifiez jamais le cordon secteur ou la prise.
- N'utilisez pas le chargeur s'il a été soumis à des chocs ou à des dommages.
- Ne démontez pas ce chargeur.
- Pour éviter les risques de chocs électriques, débranchez le chargeur de la prise avant de le nettoyer ou lorsqu'il est inutilisé.
- Ce chargeur a été conçu uniquement pour un usage à l'intérieur. N'exposez pas le chargeur à la pluie ou à une humidité excessive. Conservez le chargeur à l'abri de la poussière et de la saleté, qui peuvent causer une usure prématurée ou gêner son fonctionnement normal.
- N'utilisez jamais le chargeur comme source d'alimentation pour un appareil électrique.
- Cet appareil n'est pas destiné à être utilisé par des personnes (notamment des enfants) dont les capacités physiques, sensorielles ou intellectuelles sont réduites, ou par des personnes manquant d'expérience ou de connaissances, à moins que celles-ci ne soient sous surveillance ou qu'elles aient reçu des instructions quant à l'utilisation de l'appareil par une personne responsable de leur sécurité.
- Veuillez à ce que les enfants ne puissent pas jouer avec les appareils.
- Pour réduire le risque d'endommager la prise ou le cordon secteur, débranchez le chargeur en tirant sur la prise et non sur le cordon.
- N'utilisez pas le chargeur si le cordon ou la prise est endommagé.
- Évitez de charger des piles abîmées ou présentant un risque de fuite.

Care:

- Wipe the charger with a damp cloth occasionally without harsh chemicals, cleaning solvents or strong detergents.
- Charger and batteries must be disposed of separately. Inform yourself about the separate collection system for electrical and electronic products.

Operating Instructions

General charging guidelines

- At the same time you can charge 2 or 4 AA/AAA batteries. If you charge only two batteries, insert them in the first two slots on the left side.
- For long battery life, always charge empty batteries.
- When charging, ambient temperature should be between 0°C and 40°C (32°F and 104°F).
- You can only charge batteries of the same size and type (AA/AAA).
- Make sure batteries in each pair of slots (1/2 and/or 3/4) are identical (same capacity and size).

Note: It is normal for the unit and the batteries to become warm while charging.

Charging batteries

- Insert batteries in the charger.
- For AAA batteries flip down the charger contacts. See fig. A.
- Connect the DC output plug of the adapter into the DC input jack of the charger and plug the adapter into a household electric outlet. See fig. B.
- The green POWER LED will illuminate.
- The red CHARGE LED will illuminate indicating that charging is in progress.
- > If any of the batteries is not installed correctly, the CHARGE LED will not light and the charger will not charge empty batteries.
- > If any of the batteries is not suitable for charging (i.e. a bad battery), the CHARGE LED will flash red and the battery/batteries will not be charged.
- When the batteries are fully charged, the red CHARGE LED will turn off.
- The charger will now switch over to trickle charge to keep your batteries fully charged for use.
- When you are going to use the batteries, disconnect the plug from the outlet and remove the batteries. See fig. C. Always unplug when charged!
- The SCB4330NB battery charger can be powered by the car's 12V DC accessory (cigarette lighter) socket. Only use the supplied car cord.

Battery charging times:

Battery size	Battery capacity (mAh)	Approx. charging time
AA Ni-MH	2600 mAh	5 hrs
AA Ni-MH	2450 mAh	4 ½ hrs
AA Ni-MH	2100 mAh	4 hrs
AA Ni-MH	1800 mAh	3 ½ hrs
AA Ni-MH	1300 mAh	2 ½ hrs
AAA Ni-MH	900 mAh	5 hrs
AAA Ni-MH	700 mAh	3 ½ hrs

Note: It is normal for the unit and the batteries to become warm while charging.

Charging batteries

- Insert batteries in the charger.
- For AAA batteries flip down the charger contacts. See fig. A.
- Connect the DC output plug of the adapter into the DC input jack of the charger and plug the adapter into a household electric outlet. See fig. B.
- The green POWER LED will illuminate.
- The red CHARGE LED will illuminate indicating that charging is in progress.
- > If any of the batteries is not installed correctly, the CHARGE LED will not light and the charger will not charge empty batteries.
- > If any of the batteries is not suitable for charging (i.e. a bad battery), the CHARGE LED will flash red and the battery/batteries will not be charged.
- When the batteries are fully charged, the red CHARGE LED will turn off.
- The charger will now switch over to trickle charge to keep your batteries fully charged for use.
- When you are going to use the batteries, disconnect the plug from the outlet and remove the batteries. See fig. C. Always unplug when charged!
- The SCB4330NB battery charger can be powered by the car's 12V DC accessory (cigarette lighter) socket. Only use the supplied car cord.

Battery charging times:

Battery size	Battery capacity (mAh)	Approx. charging time
AA Ni-MH	2600 mAh	5 hrs
AA Ni-MH	2450 mAh	4 ½ hrs
AA Ni-MH	2100 mAh	4 hrs
AA Ni-MH	1800 mAh	3 ½ hrs
AA Ni-MH	1300 mAh	2 ½ hrs
AAA Ni-MH	900 mAh	5 hrs
AAA Ni-MH	700 mAh	3 ½ hrs

Note: It is normal for the unit and the batteries to become warm while charging.

Charging batteries

- Insert batteries in the charger.
- For AAA batteries flip down the charger contacts. See fig. A.
- Connect the DC output plug of the adapter into the DC input jack of the charger and plug the adapter into a household electric outlet. See fig. B.
- The green POWER LED will illuminate.
- The red CHARGE LED will illuminate indicating that charging is in progress.
- > If any of the batteries is not installed correctly, the CHARGE LED will not light and the charger will not charge empty batteries.
- > If any of the batteries is not suitable for charging (i.e. a bad battery), the CHARGE LED will flash red and the battery/batteries will not be charged.
- When the batteries are fully charged, the red CHARGE LED will turn off.
- The charger will now switch over to trickle charge to keep your batteries fully charged for use.
- When you are going to use the batteries, disconnect the plug from the outlet and remove the batteries. See fig. C. Always unplug when charged!
- The SCB4330NB battery charger can be powered by the car's 12V DC accessory (cigarette lighter) socket. Only use the supplied car cord.

Battery charging times:

Battery size	Battery capacity (mAh)	Approx. charging time
AA Ni-MH	2600 mAh	5 hrs
AA Ni-MH	2450 mAh	4 ½ hrs
AA Ni-MH	2100 mAh	4 hrs
AA Ni-MH	1800 mAh	3 ½ hrs
AA Ni-MH	1300 mAh	2 ½ hrs
AAA Ni-MH	900 mAh	5 hrs
AAA Ni-MH	700 mAh	3 ½ hrs

Note: It is normal for the unit and the batteries to become warm while charging.

Charging batteries

- Insert batteries in the charger.
- For AAA batteries flip down the charger contacts. See fig. A.
- Connect the DC output plug of the adapter into the DC input jack of the charger and plug the adapter into a household electric outlet. See fig. B.
- The green POWER LED will illuminate.
- The red CHARGE LED will illuminate indicating that charging is in progress.
- > If any of the batteries is not installed correctly, the CHARGE LED will not light and the charger will not charge empty batteries.
- > If any of the batteries is not suitable for charging (i.e. a bad battery), the CHARGE LED will flash red and the battery/batteries will not be charged.
- When the batteries are fully charged, the red CHARGE LED will turn off.
- The charger will now switch over to trickle charge to keep your batteries fully charged for use.
- When you are going to use the batteries, disconnect the plug from the outlet and remove the batteries. See fig. C. Always unplug when charged!
- The SCB4330NB battery charger can be powered by the car's 12V DC accessory (cigarette lighter) socket. Only use the supplied car cord.

SCB4330CB/SCB4356NB/SCB4365NB/SCB4380NB
200 min (car) charger

Importantes instrucciones de seguridad:

Guarde estas instrucciones - este manual contiene importantes instrucciones de seguridad y funcionamiento sobre este cargador. Antes de utilizar el cargador, lea todas las instrucciones e instrucciones de advertencia sobre el cargador, las pilas que se van a cargar y los productos que utilizarán las pilas.

Advertencias:

- Utilice este producto únicamente para cargar pilas Ni-MH. Evite cargar pilas alcalinas, de carbono, zinc, litio o de cualquier otro tipo no especificado en el cargador. Otros tipos de pilas pueden explotar o perder, causando lesiones personales.
- Para colocar a las pilas correctamente, observe las indicaciones de polaridad (+/-). Véase la fig. A.
- No tire el producto al fuego ni lo cortocircuite ni lo abra.
- Neuue Akkus vor dem Gebrauch laden.
- Chargeur toujours à l'abri de la poussière et de la saleté, qui peuvent causer une usure prématurée ou gêner son fonctionnement normal.
- N'utilisez pas le chargeur s'il a été soumis à des chocs ou à des dommages.
- Ne démontez pas ce chargeur.
- Pour éviter les risques de chocs électriques, débranchez le chargeur de la prise avant de le nettoyer ou lorsqu'il est inutilisé.
- Ce chargeur a été conçu uniquement pour un usage à l'intérieur. N'exposez pas le chargeur à la pluie ou à une humidité excessive. Conservez le chargeur à l'abri de la poussière et de la saleté, qui peuvent causer une usure prématurée ou gêner son fonctionnement normal.
- N'utilisez jamais le chargeur comme source d'alimentation pour un appareil électrique.
- Cet appareil n'est pas destiné à être utilisé par des personnes (notamment des enfants) dont les capacités physiques, sensorielles ou intellectuelles sont réduites, ou par des personnes manquant d'expérience ou de connaissances, à moins que celles-ci ne soient sous surveillance ou qu'elles aient reçu des instructions quant à l'utilisation de l'appareil par une personne responsable de leur sécurité.
- Veuillez à ce que les enfants ne puissent pas jouer avec les appareils.
- Pour réduire le risque d'endommager la prise ou le cordon secteur, débranchez le chargeur en tirant sur la prise et non sur le cordon.
- N'utilisez pas le chargeur si le cordon ou la prise est endommagé.
- Évitez de charger des piles abîmées ou présentant un risque de fuite.

Care:

- Wipe the charger with a damp cloth occasionally without harsh chemicals, cleaning solvents or strong detergents.
- Charger and batteries must be disposed of separately. Inform yourself about the separate collection system for electrical and electronic products.

Operating Instructions

General charging guidelines

- At the same time you can charge 2 or 4 AA/AAA batteries. If you charge only two batteries, insert them in the first two slots on the left side.
- For long battery life, always charge empty batteries.
- When charging, ambient temperature should be between 0°C and 40°C (32°F and 104°F).
- You can only charge batteries of the same size and type (AA/AAA).
- Make sure batteries in each pair of slots (1/2 and/or 3/4) are identical (same capacity and size).

Note: It is normal for the unit and the batteries to become warm while charging.

Charging batteries

- Insert batteries in the charger.
- For AAA batteries flip down the charger contacts. See fig. A.
- Connect the DC output plug of the adapter into the DC input jack of the charger and plug the adapter into a household electric outlet. See fig. B.
- The green POWER LED will illuminate.
- The red CHARGE LED will illuminate indicating that charging is in progress.
- > If any of the batteries is not installed correctly, the CHARGE LED will not light and the charger will not charge empty batteries.
- > If any of the batteries is not suitable for charging (i.e. a bad battery), the CHARGE LED will flash red and the battery/batteries will not be charged.
- When the batteries are fully charged, the red CHARGE LED will turn off.
- The charger will now switch over to trickle charge to keep your batteries fully charged for use.
- When you are going to use the batteries, disconnect the plug from the outlet and remove the batteries. See fig. C. Always unplug when charged!
- The SCB4330NB battery charger can be powered by the car's 12V DC accessory (cigarette lighter) socket. Only use the supplied car cord.

Battery charging times:

Battery size	Battery capacity (mAh)	Approx. charging time
AA Ni-MH	2600 mAh	5 hrs
AA Ni-MH	2450 mAh	4 ½ hrs
AA Ni-MH	2100 mAh	4 hrs
AA Ni-MH	1800 mAh	3 ½ hrs
AA Ni-MH	1300 mAh	2 ½ hrs
AAA Ni-MH	900 mAh	5 hrs
AAA Ni-MH	700 mAh	3 ½ hrs

Note: It is normal for the unit and the batteries to become warm while charging.

Charging batteries

- Insert batteries in the charger.
- For AAA batteries flip down the charger contacts. See fig. A.
- Connect the DC output plug of the adapter into the DC input jack of the charger and plug the adapter into a household electric outlet. See fig. B.
- The green POWER LED will illuminate.
- The red CHARGE LED will illuminate indicating that charging is in progress.
- > If any of the batteries is not installed correctly, the CHARGE LED will not light and the charger will not charge empty batteries.
- > If any of the batteries is not suitable for charging (i.e. a bad battery), the CHARGE LED will flash red and the battery/batteries will not be charged.
- When the batteries are fully charged, the red CHARGE LED will turn off.
- The charger will now switch over to trickle charge to keep your batteries fully charged for use.
- When you are going to use the batteries, disconnect the plug from the outlet and remove the batteries. See fig. C. Always unplug when charged!
- The SCB4330NB battery charger can be powered by the car's 12V DC accessory (cigarette lighter) socket. Only use the supplied car cord.

Battery charging times:

Battery size	Battery capacity (mAh)	Approx. charging time
AA Ni-MH	2600 mAh	5 hrs
AA Ni-MH	2450 mAh	4 ½ hrs
AA Ni-MH	2100 mAh	4 hrs
AA Ni-MH	1800 mAh	3 ½ hrs
AA Ni-MH	1300 mAh	2 ½ hrs
AAA Ni-MH	900 mAh	5 hrs
AAA Ni-MH	700 mAh	3 ½ hrs

Note: It is normal for the unit and the batteries to become warm while charging.

Charging batteries

- Insert batteries in the charger.
- For AAA batteries flip down the charger contacts. See fig. A.
- Connect the DC output plug of the adapter into the DC input jack of the charger and plug the adapter into a household electric outlet. See fig. B.
- The green POWER LED will illuminate.
- The red CHARGE LED will illuminate indicating that charging is in progress.
- > If any of the batteries is not installed correctly, the CHARGE LED will not light and the charger will not charge empty batteries.
- > If any of the batteries is not suitable for charging (i.e. a bad battery), the CHARGE LED will flash red and the battery/batteries will not be charged.
- When the batteries are fully charged, the red CHARGE LED will turn off.
- The charger will now switch over to trickle charge to keep your batteries fully charged for use.
- When you are going to use the batteries, disconnect the plug from the outlet and remove the batteries. See fig. C. Always unplug when charged!
- The SCB4330NB battery charger can be powered by the car's 12V DC accessory (cigarette lighter) socket. Only use the supplied car cord.

Battery charging times:

Battery size	Battery capacity (mAh)	Approx. charging time
AA Ni-MH	2600 mAh	5 hrs
AA Ni-MH	2450 mAh	4 ½ hrs
AA Ni-MH	2100 mAh	4 hrs
AA Ni-MH	1800 mAh	3 ½ hrs
AA Ni-MH	1300 mAh	2 ½ hrs
AAA Ni-MH	900 mAh	5 hrs
AAA Ni-MH	700 mAh	3 ½ hrs

Note: It is normal for the unit and the batteries to become warm while charging.

Charging batteries

- Insert batteries in the charger.
- For AAA batteries flip down the charger contacts. See fig. A.
- Connect the DC output plug of the adapter into the DC input jack of the charger and plug the adapter into a household electric outlet. See fig. B.
- The green POWER LED will illuminate.
- The red CHARGE LED will illuminate indicating that charging is in progress.
- > If any of the batteries is not installed correctly, the CHARGE LED will not light and the charger will not charge empty batteries.
- > If any of the batteries is not suitable for charging (i.e. a bad battery), the CHARGE LED will flash red and the battery/batteries will not be charged.
- When the batteries are fully charged, the red CHARGE LED will turn off.
- The charger will now switch over to trickle charge to keep your batteries fully charged for use.
- When you are going to use the batteries, disconnect the plug from the outlet and remove the batteries. See fig. C. Always unplug when charged!
- The SCB4330NB battery charger can be powered by the car's 12V DC accessory (cigarette lighter) socket. Only use the supplied car cord.

SCB4330CB/SCB4356NB/SCB4365NB/SCB4380NB
200 min (car) charger

Wichtige Sicherheitshinweise:

Behalten Sie diese Hinweise gut auf - diese Anleitung enthält wichtige Sicherheits- und Anwendungshinweise zu diesem Ladegerät. Lesen Sie vor dem Gebrauch des Ladegeräts alle Anweisungen und die Sicherheits- und Warnhinweise selbst, auf den zu ladenden Akkus und auf den Produkten, die mit den Akkus betrieben werden.

Warnung:

- Benutze dieses Produkt ausschließlich zum Laden von NiMH-Akkus. Es dürfen keine Alkali-, Zink-Kohle- oder Lithiumbatterien geladen werden oder andere, nicht auf dem Ladegerät angegebene Typen. Andere Batterietypen können unter Umständen Schaden anrichten und zu Personenschäden oder Personenschäden führen.
- Para colocar a las pilas correctamente, observe las indicaciones de polaridad (+/-). Véase la fig. A.
- No tire el producto al fuego ni lo cortocircuite ni lo abra.
- Neuue Akkus vor dem Gebrauch laden.
- Chargeur toujours à l'abri de la poussière et de la saleté, qui peuvent causer une usure prématurée ou gêner son fonctionnement normal.
- N'utilisez pas le chargeur s'il a été soumis à des chocs ou à des dommages.
- Ne démontez pas ce chargeur.
- Pour éviter les risques de chocs électriques, débranchez le chargeur de la prise avant de le nettoyer ou lorsqu'il est inutilisé.
- Ce chargeur a été conçu uniquement pour un usage à l'intérieur. N'exposez pas le chargeur à la pluie ou à une humidité excessive. Conservez le chargeur à l'abri de la poussière et de la saleté, qui peuvent causer une usure prém

